

APARNA CONSTRUCTION

(DEALING WITH REAL ESTATE)

87/49, A. K. MUKHERJEE ROAD, KOLKATA-700 090

PROJECT:

Ref. No.

G+IV STORIED (15.500 MTR. HEIGHT) RESIDENTIAL BUILDING PLAN U/S 393A OF K.M.C. ACT 1980 AND K.M.C. BUILDING RULES 2009 AT PREMISES NO. 37B, BARRACKPORE TRUNK ROAD, WARD NO.-001, BOROUGH NO.-I, UNDER THE KOLKATA MUNICIPAL CORPORATION P.S.- COSSIPORE, KOLKATA-700 002

APPLICANT

SRI BIRENDRA NATH GHOSH (PROPRIETOR OF APARNA CONSTRUCTION)

LATITUDE & LONGITUDE HAS BEEN MEASURED NEAR THE CENTER OF THE PLOT.

Latitude : 22.3738N
Longitude: 88.2240E

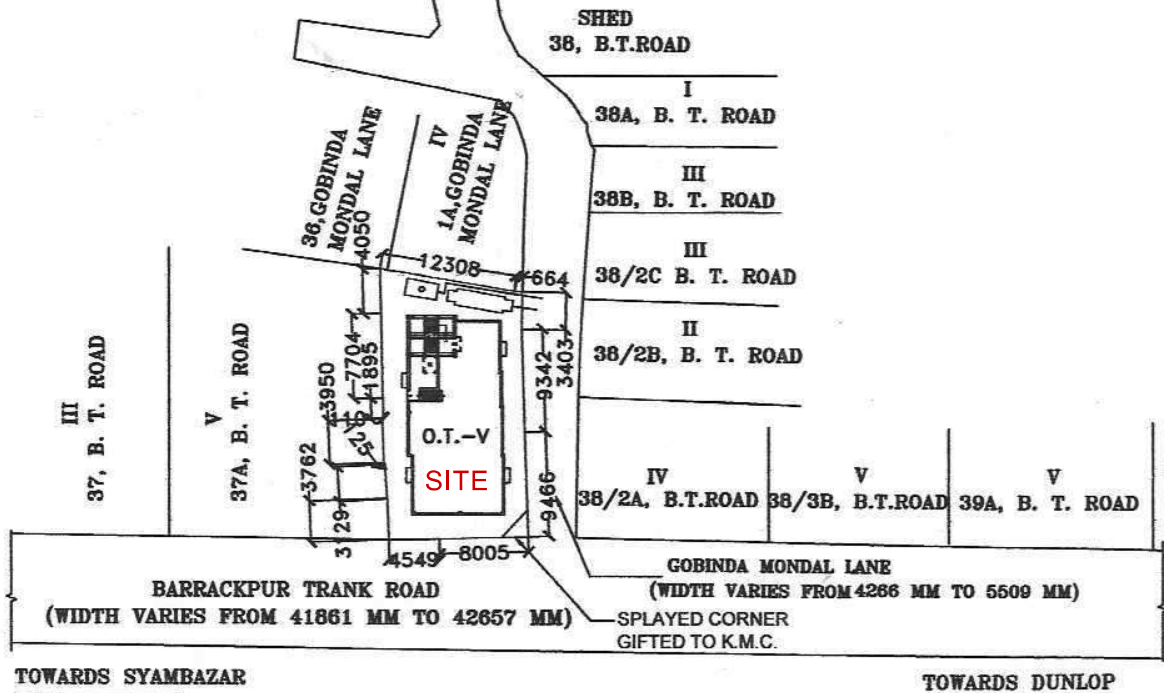
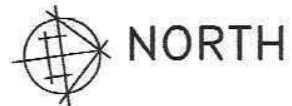

SITE PLAN
SCALE :-1:600

APARNA CONSTRUCTION

Sri Birendra Nath Ghosh
Proprietor